

Project: Grove Airfield Northern Extension

Title: Red Line Plan

Client: Taylor Wimpey and Persimmon Homes
Status: Final

Job No: TAYA2041
Date: Feb 2013
Dwg No: 1001
Scale: 1:7500@A3
Revision: -
Author: AJ

Plans reproduced by permission of Ordnance Survey on behalf of The Controller of Her Majesty's Stationery Office.
© Crown Copyright and database right [2013]. All rights reserved. Ordnance Survey Licence number [100020449].





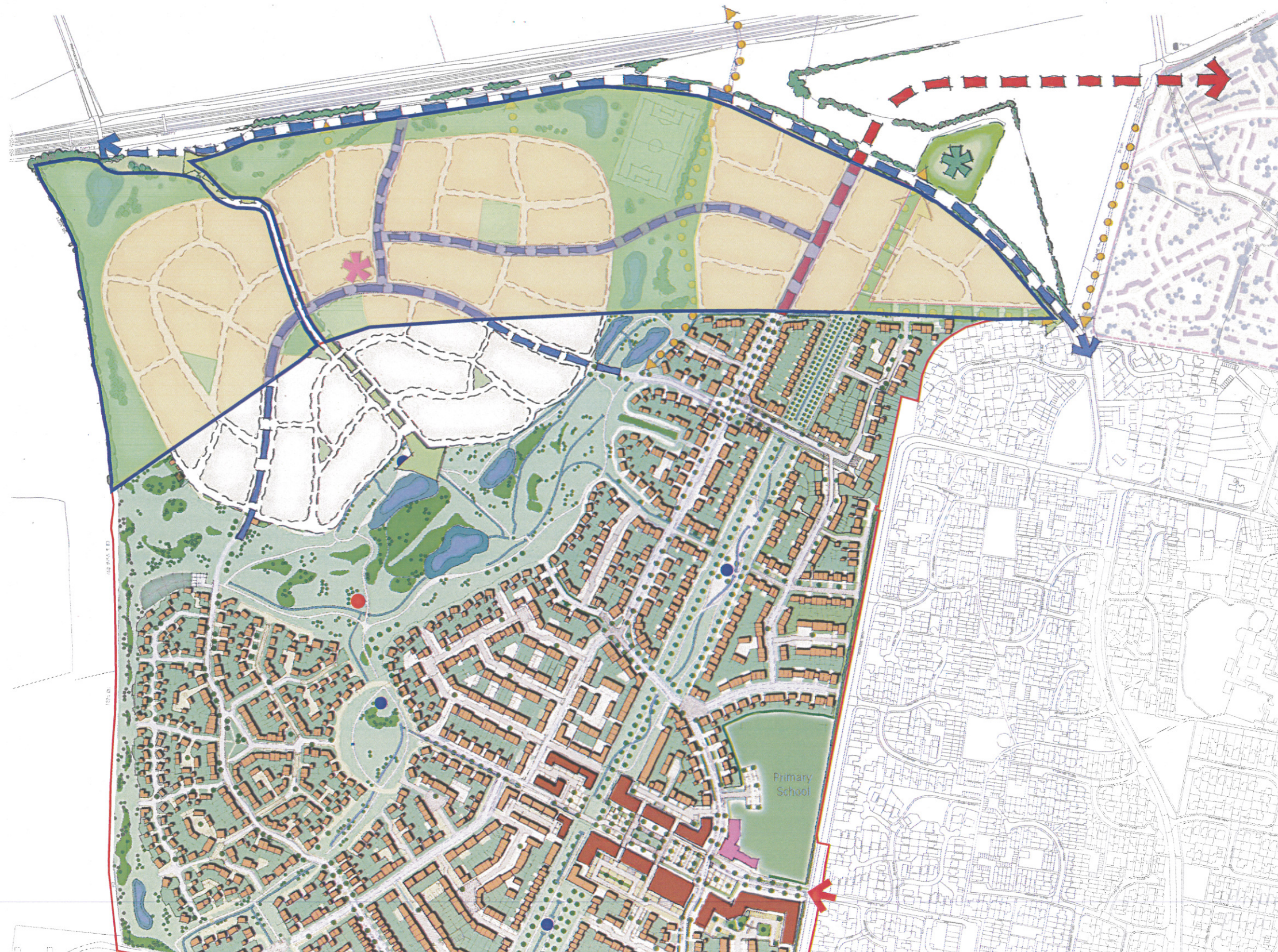



TURLEYASSOCIATES
www.turleyassociates.co.uk

This drawing is for illustrative purposes only and should not be used for any construction or estimation purposes. Do not scale drawings. No liability or responsibility is accepted arising from reliance upon the information contained in this drawing



The scaling of this drawing cannot be assured

Revision	Date	Drn	Ckd
-	-	-	-

-  Site Boundary
-  Northern Site Boundary
-  Development Blocks
-  Primary Route
-  Secondary Routes
-  Pedestrian Links
-  Green Link
-  Local Centre

Approximate Land Budget for Northern Area:

	Northern Site Boundary	26.66Ha
	Residential	16.83Ha
	Public Open Space	8.28Ha
	Infrastructure	1.55Ha

Note:

This draft plan has been prepared without any technical constraints information and should be treated as indicative.

Project
**Former Airfield
 West of Grove**
 Drawing Title
Capacity Test of Northern Area

Date 19.06.12	Scale 1:5000	Drawn by EM	Check by KP
Project No 18229	Drawing No -	Revision -	

**BARTON
WILLMORE**

Planning • Master Planning & Urban Design
 Architecture • Landscape Planning & Design • Project Services
 Environmental & Sustainability Assessment • Graphic Design

bartonwillmore.co.uk

